

1  
2  
3  
4  
5  
6



### 3514-P



- Standard accessories**
- 1 Set of hard solid ID jaws
  - 1 Set of hard solid OD jaws
  - 1 Wrench
- Spare parts 99-141  
Technical data 142-148

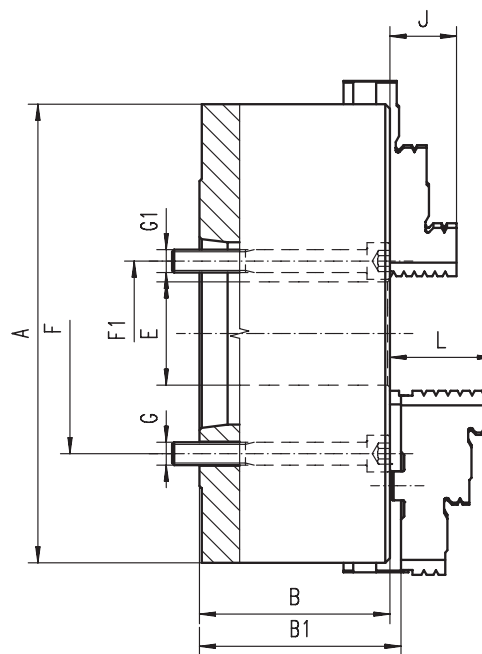

- BISON PREMIUM chucks are characterized by exceptionally high accuracy values for all operations that require maximum precision - specially designed for our most demanding customers
- Hardened and ground working surfaces
- Balanced scroll plate
- Chucks ø20" and above have additional T-slots

Code No.	Type
7-822-0615P	3514-6"-5-P
7-822-0815P	3514-8"-5-P
7-822-0816P	3514-8"-6-P
7-822-1015P	3514-10"-5-P
7-822-1016P	3514-10"-6-P
7-822-1018P	3514-10"-8-P
7-822-1226P	3514-12"-6-P
7-822-1228P	3514-12"-8-P
7-822-1628P	3514-16"-8-P
7-822-1629P	3514-16"-11-P
7-822-2028P	3514-20"-8-P
7-822-2029P	3514-20"-11-P
7-822-2529P	3514-25"-11-P
7-822-2530P	3514-25"-15-P

A [in]	Taper Size	B [in]	B1 [in]	E [in]	F [in]	F1 [in]	Number of bolts	G	G1	J [in]	L [in]	Weight [lbs]
6.30	5	2.68	2.87	1.65	-	2.44	3	-	3xM10	1.26	1.69	22.05
7.87	5	3.07	3.26	1.65	-	2.44	3	-	3xM10	1.14	1.77	41.89
7.87	6	3.07	3.26	2.17	-	3.25	3	-	3xM12	1.14	1.77	41.89
9.84	5	3.50	3.65	2.99	4.13	-	3	3xM10	-	1.34	2.09	70.55
9.84	6	3.50	3.65	2.17	-	3.25	6	-	6xM12	1.34	2.09	70.55
9.84	8	3.50	3.65	2.99	-	4.37	6	-	6xM16	1.34	2.09	70.55
12.40	6	3.79	3.99	4.06	5.25	-	6	6xM12	-	1.69	2.24	121.25
12.40	8	3.79	3.99	3.15	-	4.37	6	-	6xM16	1.69	2.24	121.25
15.75	8	4.25	4.60	5.35	6.75	-	6	6xM16	-	2.17	2.64	202.83
15.75	11	4.25	4.60	5.12	-	6.50	6	-	6xM20	2.17	2.64	202.83
19.69	8	4.69	5.11	5.35	6.75	-	6	6xM16	-	2.36	3.11	352.74
19.69	11	4.69	5.11	7.48	9.25	-	6	6xM20	-	2.36	3.11	352.74
24.80	11	5.08	5.52	7.48	9.25	-	6	6xM20	-	2.76	3.43	628.32
24.80	15	5.08	5.52	9.92	13.00	-	6	6xM24	-	2.76	3.43	628.32

Larger diameters available on page 82-93!



### 3515-P



- Standard accessories**
- 1 Set of hard top jaws
  - 1 Set of hard master jaws
  - 1 Wrench
- Spare parts 99-141  
Technical data 142-148

Type	Code No.
3515-6"-5-P	7-821-0615P
3515-8"-5-P	7-821-0815P
3515-8"-6-P	7-821-0816P
3515-10"-5-P	7-821-1015P
3515-10"-6-P	7-821-1016P
3515-10"-8-P	7-821-1018P
3515-12"-6-P	7-821-1226P
3515-12"-8-P	7-821-1228P
3515-16"-8-P	7-821-1628P
3515-16"-11-P	7-821-1629P
3515-20"-8-P	7-821-2028P
3515-20"-11-P	7-821-2029P
3515-25"-11-P	7-821-2529P
3515-25"-15-P	7-821-2530P

3514-P  
3515-P