

- STANDARD PRECISION CHUCK
- CAST IRON BODY

9416



Standard accessories



1 Set of hard top jaws



1 Set of hard master jaws



1 Wrench + Ratchet

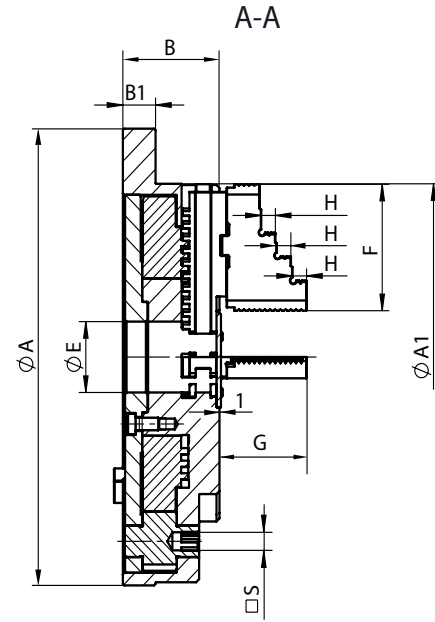
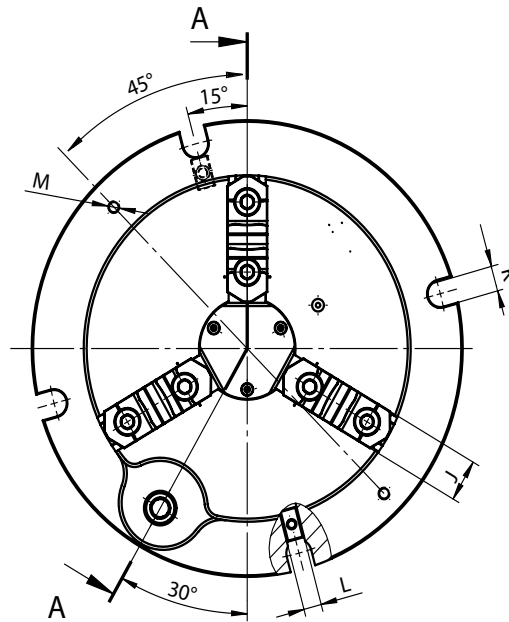

- Wide clamping range with long jaw travel
- Fixture is sealed against chips
- Low-profile fixture

Code No.	Type	Ø A [in]	Ø A1 [in]	B [in]	B1 [in]	Ø E [in]	F [in]	G [in]	H [in]	J [in]	K [in]	L [in]	M [in]	□ S	n x J	Weight [lbs]
7-640-0630	9416-6"	9.33	6.89	2.05	0.67	1.26	2.64	2.01	0.33	0.98	0.67	0.47	-	0.35	0.12	27
7-640-0830	9416-8"	11.42	8.66	2.56	0.87	1.77	3.15	2.31	0.37	1.06	0.67	0.47	-	0.43	0.12	52
7-640-1030	9416-10"	13.78	10.83	2.87	0.87	2.24	3.74	2.50	0.47	1.28	0.79	0.71	M8	0.55	0.12	83
7-640-1230	9416-12"	15.95	13.19	3.15	0.95	3.15	4.33	2.81	0.51	1.46	0.79	0.71	M8	0.55	0.12	129