

- 1
- 2
- 3
- 4
- 5

5901

Simple and compact design provides for three types of indexing:

- 1) basic indexing - which is done by means of catch device in 2, 3, 4, 6, 8, 12 and 24 divisions
- 2) angular indexing - which can be performed through sleeve with scale graduated in 360° in 1° increment
- 3) alternative indexing - which can be performed by means of catch device and specified changeable dividing plate (with Z=13, 14, 15, 16, 17, 18, 19, 20, 21, 22, 23 or 24 units number of divisions). To obtain required number of divisions replace Z=24 plate with one of the above specified plates.

- Indexing accuracy 2'
- True run-out of tapered centre bore 0.02mm
- Squareness (base to chuck) 0.02mm
- Parallelism over face 0.02mm
- Concentricity of mounting flange with precision or standard chuck 0.03±0.06mm
- Dividing plate made of high-quality alloy steel, hardened and ground
- Body made of cast iron
- Designed for equal or unequal precision indexing in milling, drilling and related machining operations
- Chuck not included

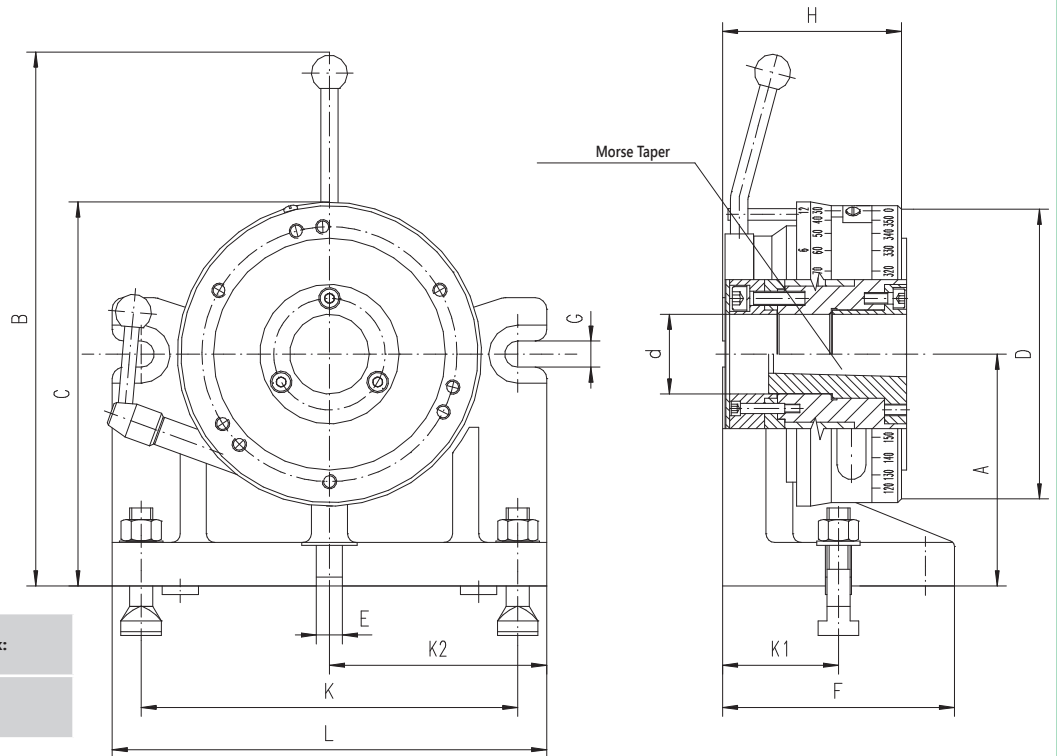
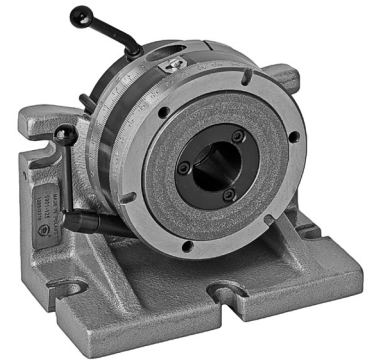

Please select an appropriate chuck:

| Solid jaws | 2-piece jaws | |
|------------------|------------------|-----------------------|
| 3274 (7-811-...) | 3275 (7-812-...) | 3-jaw, cast iron body |
| 3574 (7-817-...) | 3575 (7-813-...) | 3-jaw, steel body |
| 3674 (7-815-...) | 3675 (7-814-...) | 4-jaw, cast iron body |
| 3774 (7-844-...) | 3775 (7-814-...) | 4-jaw, steel body |

A - For tailstock D - For chuck * - 7-812-... chuck included

| Code No. (no chuck) | Code No. (with chuck)* | Type | A | B | C | D | d | Morse Taper | E | F | G | H | K | K1 | K2 | L | Permissible weight of workpieces | | | | Weight |
|---------------------|------------------------|----------|------|-----|-------|------|------|-------------|-------|-----|----|-------|-------|----|-------|-----|----------------------------------|--------------|-----------------|--------------|--------|
| | | | | | | | | | | | | | | | | | with chuck | | without chuck | | |
| | | | | | | | | | | | | | | | | | without support | with support | without support | with support | |
| | | | [mm] | | | [mm] | | | [daN] | | | | [lbs] | | | | | | | | |
| 7-609-015 | - | 5901-100 | 100 | 256 | 167.5 | 125 | 38.5 | 3 | 18 | 130 | 14 | 109.5 | 185 | 65 | 107.5 | 215 | 20 | 40 | 30 | 60 | 30.9 |
| 7-609-016 | 7-609-006 | 5901-125 | 125 | 301 | 210.0 | 160 | 42 | 3 | 18 | 140 | 14 | 108.5 | 215 | 70 | 122.5 | 245 | 30 | 60 | 40 | 70 | 50.7 |
| 7-609-018 | 7-609-008 | 5901-160 | 160 | 382 | 265.0 | 200 | 55 | 4 | 18 | 160 | 18 | 123.5 | 260 | 80 | 150.0 | 300 | 35 | 70 | 51 | 86 | 90.4 |