



HEAVY DUTY REVOLVING CENTERS

- TRIPLE BEARING DESIGN
- HEAVY DUTY



8809

- Hollow-tipped HD revolving centers with 60° point

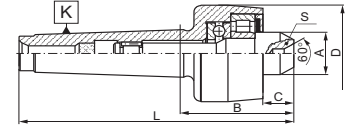
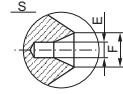
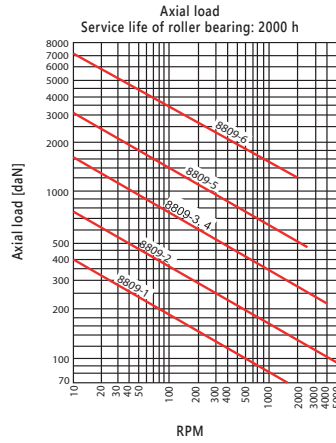
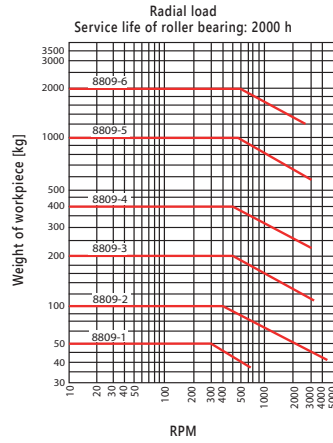

K MT	Max. weight [lbs]	RPM	Max. concentr. error	Code No.	Max. concentr. error	Code No.	A [in]	B [in]	C [in]	D [in]	L [in]	E [in]	F [in]
			[in] Precision		[in] Standard								
1	110	5,000	0.0002	7-554-101	0.0003	7-554-001	0.59	1.73	0.45	1.50	3.84	0.10	0.17
2	220	5,000	0.0001	7-554-102	0.0003	7-554-002	0.71	2.01	0.63	1.57	4.53	0.10	0.21
3	440	4,000	0.0001	7-554-103	0.0003	7-554-003	0.98	2.60	0.73	2.20	5.79	0.16	0.33
4	880	3,000	0.0001	7-554-104	0.0003	7-554-004	1.26	2.80	0.77	2.52	6.81	0.25	0.52
5	2,200	2,500	0.0002	7-554-105	0.0004	7-554-005	1.57	3.72	1.22	3.35	8.82	0.25	0.52
6	4,400	2,000	0.0002	7-554-106	0.0004	7-554-006	2.46	5.16	1.73	5.12	12.32	0.39	0.83

8810

- Carbide-tipped HD revolving centers with 60° point

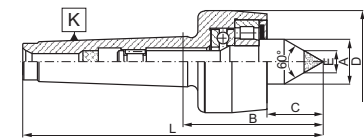
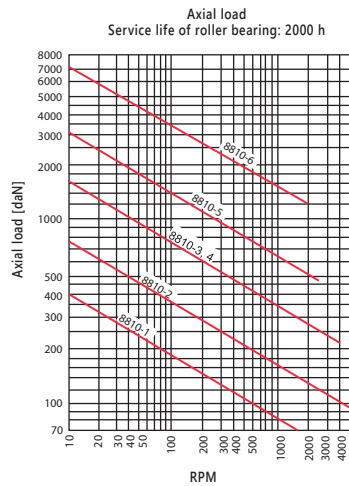
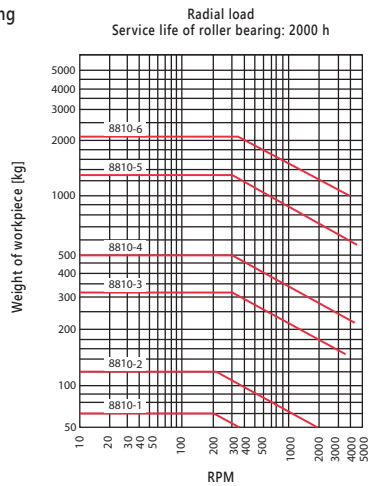

K MT	Max. weight [lbs]	RPM	Max. concentr. error	Code No.	Max. concentr. error	Code No.	A [in]	B [in]	C [in]	D [in]	E [in]	L [in]
			[in] Precision		[in] Standard							
1	132	5,000	0.0002	7-553-101	0.0003	7-553-001	0.59	1.95	0.67	1.50	0.28	4.06
2	264	5,000	0.0001	7-553-102	0.0003	7-553-002	0.71	2.22	0.85	1.57	0.28	4.74
3	704	4,000	0.0001	7-553-103	0.0003	7-553-003	0.98	2.95	1.08	2.20	0.43	6.14
4	1,100	3,000	0.0001	7-553-104	0.0003	7-553-004	1.26	3.35	1.32	2.52	0.55	7.36
5	2,750	2,500	0.0002	7-553-105	0.0004	7-553-005	1.57	4.25	1.73	3.35	0.71	9.33
6	4,840	2,000	0.0002	7-553-106	0.0004	7-553-006	2.46	5.96	2.52	5.12	0.71	13.13