

7630

■ Shrink fit holders

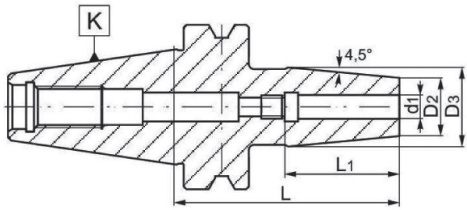

* Suitable for HSS and solid carbide tools with cylindrical shank (h6 tolerance)

| Code No. | K 7:24 | d ₁ [mm] | L [mm] | L ₁ [mm] | D ₂ [mm] | D ₃ [mm] |
|-----------|-----------|------------------------|-----------|------------------------|------------------------|------------------------|
| 7-018-402 | CAT40 | 3 | 80 | 36 | 14 | 22 |
| 7-018-404 | CAT40 | 3 | 120 | 36 | 14 | 22 |
| 7-018-406 | CAT40 | 3 | 160 | 36 | 14 | 22 |
| 7-018-408 | CAT40 | 4 | 80 | 36 | 14 | 22 |
| 7-018-410 | CAT40 | 4 | 120 | 36 | 14 | 22 |
| 7-018-412 | CAT40 | 4 | 160 | 36 | 15 | 22 |
| 7-018-414 | CAT40 | 5 | 80 | 36 | 16 | 22 |
| 7-018-416 | CAT40 | 5 | 120 | 36 | 16 | 22 |
| 7-018-418 | CAT40 | 5 | 160 | 36 | 16 | 22 |
| 7-018-420 | CAT40 | 6 | 80 | 36 | 21 | 27 |
| 7-018-422 | CAT40 | 6 | 120 | 36 | 21 | 27 |
| 7-018-424 | CAT40 | 6 | 160 | 36 | 21 | 27 |
| 7-018-426 | CAT40 | 8 | 80 | 36 | 21 | 27 |
| 7-018-428 | CAT40 | 8 | 120 | 36 | 21 | 27 |
| 7-018-430 | CAT40 | 8 | 160 | 36 | 21 | 27 |
| 7-018-432 | CAT40 | 10 | 80 | 42 | 24 | 32 |
| 7-018-434 | CAT40 | 10 | 120 | 42 | 24 | 32 |
| 7-018-436 | CAT40 | 10 | 160 | 42 | 24 | 32 |
| 7-018-438 | CAT40 | 12 | 80 | 47 | 24 | 32 |
| 7-018-440 | CAT40 | 12 | 120 | 47 | 24 | 32 |
| 7-018-442 | CAT40 | 12 | 160 | 47 | 24 | 32 |
| 7-018-444 | CAT40 | 14 | 80 | 47 | 27 | 34 |
| 7-018-446 | CAT40 | 14 | 120 | 47 | 27 | 34 |
| 7-018-448 | CAT40 | 14 | 160 | 47 | 27 | 34 |
| 7-018-450 | CAT40 | 16 | 80 | 50 | 27 | 34 |
| 7-018-452 | CAT40 | 16 | 120 | 50 | 27 | 34 |
| 7-018-454 | CAT40 | 16 | 160 | 50 | 27 | 34 |
| 7-018-456 | CAT40 | 18 | 80 | 50 | 33 | 42 |
| 7-018-458 | CAT40 | 18 | 120 | 50 | 33 | 42 |
| 7-018-460 | CAT40 | 18 | 160 | 50 | 33 | 42 |
| 7-018-462 | CAT40 | 20 | 80 | 52 | 33 | 42 |
| 7-018-464 | CAT40 | 20 | 120 | 52 | 33 | 42 |
| 7-018-466 | CAT40 | 20 | 160 | 52 | 33 | 42 |
| 7-018-468 | CAT40 | 25 | 100 | 58 | 44 | 53 |
| 7-018-470 | CAT40 | 25 | 120 | 58 | 44 | 53 |
| 7-018-472 | CAT40 | 25 | 160 | 58 | 44 | 53 |
| 7-018-474 | CAT40 | 32 | 100 | 58 | 44 | 53 |
| 7-018-476 | CAT40 | 32 | 120 | 58 | 44 | 53 |
| 7-018-478 | CAT40 | 32 | 160 | 58 | 44 | 53 |

| Code No. | K 7:24 | d ₁ [mm] | L [mm] | L ₁ [mm] | D ₂ [mm] | D ₃ [mm] |
|-----------|-----------|------------------------|-----------|------------------------|------------------------|------------------------|
| 7-018-502 | CAT50 | 6 | 80 | 36 | 21 | 27 |
| 7-018-504 | CAT50 | 6 | 120 | 36 | 21 | 27 |
| 7-018-506 | CAT50 | 6 | 160 | 36 | 21 | 27 |
| 7-018-508 | CAT50 | 8 | 80 | 36 | 21 | 27 |
| 7-018-510 | CAT50 | 8 | 120 | 36 | 21 | 27 |
| 7-018-512 | CAT50 | 8 | 160 | 36 | 21 | 27 |
| 7-018-514 | CAT50 | 10 | 80 | 42 | 24 | 32 |
| 7-018-516 | CAT50 | 10 | 120 | 42 | 24 | 32 |
| 7-018-518 | CAT50 | 10 | 160 | 42 | 24 | 32 |
| 7-018-520 | CAT50 | 12 | 80 | 47 | 24 | 32 |
| 7-018-522 | CAT50 | 12 | 120 | 47 | 24 | 32 |
| 7-018-524 | CAT50 | 12 | 160 | 47 | 24 | 32 |
| 7-018-526 | CAT50 | 14 | 80 | 47 | 27 | 34 |
| 7-018-528 | CAT50 | 14 | 120 | 47 | 27 | 34 |
| 7-018-530 | CAT50 | 14 | 160 | 47 | 27 | 34 |
| 7-018-532 | CAT50 | 16 | 80 | 50 | 27 | 34 |
| 7-018-534 | CAT50 | 16 | 120 | 50 | 27 | 34 |
| 7-018-536 | CAT50 | 16 | 160 | 50 | 27 | 34 |
| 7-018-538 | CAT50 | 18 | 80 | 50 | 33 | 42 |
| 7-018-540 | CAT50 | 18 | 120 | 50 | 33 | 42 |
| 7-018-542 | CAT50 | 18 | 160 | 50 | 33 | 42 |
| 7-018-544 | CAT50 | 20 | 80 | 52 | 33 | 42 |
| 7-018-546 | CAT50 | 20 | 120 | 52 | 33 | 42 |
| 7-018-548 | CAT50 | 20 | 160 | 52 | 33 | 42 |
| 7-018-550 | CAT50 | 25 | 100 | 58 | 44 | 53 |
| 7-018-552 | CAT50 | 25 | 120 | 58 | 44 | 53 |
| 7-018-554 | CAT50 | 25 | 160 | 58 | 44 | 53 |
| 7-018-556 | CAT50 | 32 | 100 | 58 | 44 | 53 |
| 7-018-558 | CAT50 | 32 | 120 | 58 | 44 | 53 |
| 7-018-560 | CAT50 | 32 | 160 | 58 | 44 | 53 |