

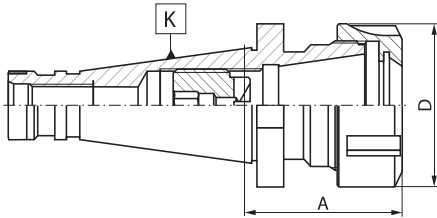

7616 QC

■ Collet chucks for ER collets - quick change version



Code No.	K 7:24	Collet size	A [in]	Clamping range [in]	D [in]	
7-171-173	NMTB 30	ER16	2.00	0.079 - 0.394	1.26	7-178-816
7-171-303	NMTB 30	ER32	2.50	0.125 - 0.750	1.97	7-188-832
7-171-403	NMTB 30	ER40	3.50	0.125 - 1.000	2.48	7-188-840
7-171-174	NMTB 40	ER16	2.50	0.079 - 0.394	1.26	7-188-816
7-171-264	NMTB 40	ER25	2.50	0.125 - 0.625	1.65	7-188-825
7-171-304	NMTB 40	ER32	3.00	0.125 - 0.750	1.97	7-188-832
7-171-404	NMTB 40	ER40	2.50	0.125 - 1.000	2.48	7-188-840
7-171-405	NMTB 50	ER40	2.75	0.125 - 1.000	2.48	7-188-840



7665

■ Collet chucks for DA180 collets

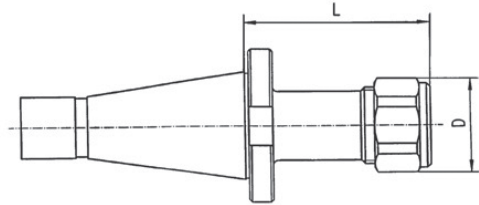

Code No.	K 7:24	Collet size	L [in]	Clamping range [in]	D [in]		
7-167-013	NMTB 30	DA180	3.00	0.25 - 0.75	1.54	7-193-818	7-193-918
7-167-014	NMTB 40	DA180	3.00	0.25 - 0.75	1.54	7-193-818	7-193-918
7-167-015	NMTB 50	DA180	3.00	0.25 - 0.75	1.54	7-193-818	7-193-918



7616

■ Collet chucks for ER collets

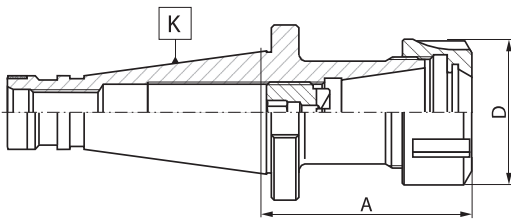

Code No.	K 7:24	Collet size	A [in]	Clamping range [in]	D [in]	
7-171-3030	NMTB 30	ER32	2.36	0.125 - 0.750	1.97	7-188-832
7-171-1740	NMTB 40	ER16	2.36	0.079 - 0.394	1.26	7-178-816
7-171-3040	NMTB 40	ER32	2.75	0.125 - 0.750	1.97	7-188-832
7-171-4040	NMTB 40	ER40	2.36	0.125 - 1.000	2.48	7-188-840



7640

■ Collet chucks for TG collets

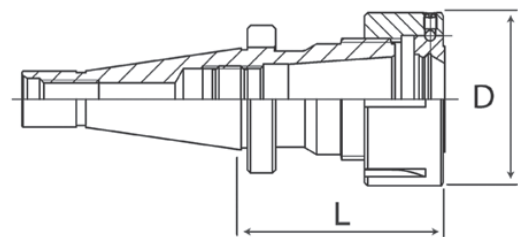

Code No.	K 7:24	Collet Size	L [in]	D [in]		
7-132-305	NMTB 30	TG75	2.50	2.125	7-180-901	7-188-932
7-132-405	NMTB 40	TG75	2.50	2.125	7-180-901	-
7-132-410	NMTB 40	TG100	3.00	2.500	7-180-9100	7-180-930
7-132-510	NMTB 50	TG100	3.50	2.500	7-180-901	7-180-930
7-132-535	NMTB 50	TG150	5.00	3.500	7-180-9150	7-180-935