

## 5133

- Keyless drill chucks for industrial and CNC use

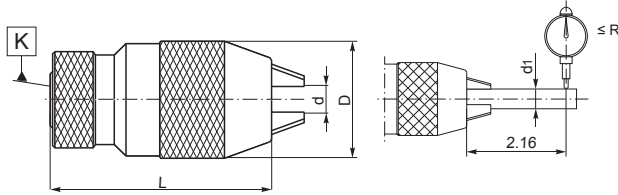

Code No.	Max. concentr. error	Clamping Range d [in]	Clamping Range d [mm]	K Jacobs	D	L	d <sub>1</sub>
7-051-135	0.005	1/32 - 1/2	1-13	2	2	3.8	1/4 - 1/2
7-051-137	0.005	1/32 - 1/2	1-13	33	2	3.8	1/4 - 1/2
7-051-138	0.005	1/32 - 1/2	1-13	6	2	3.8	1/4 - 1/2
7-051-168	0.005	1/8 - 5/8	3-16	6	2.3	4.06	1/4 - 5/8
7-051-169	0.005	1/8 - 5/8	3-16	3	2.3	4.33	1/4 - 5/8
7-051-335	0.0015	1/32 - 1/2	1-13	2	2	3.8	1/4 - 1/2
7-051-337	0.0015	1/32 - 1/2	1-13	33	2	3.8	1/4 - 1/2
7-051-338	0.0015	1/32 - 1/2	1-13	6	2	3.8	1/4 - 1/2
7-051-368	0.0015	1/8 - 5/8	3-16	6	2.3	4.06	1/4 - 5/8
7-051-369	0.0015	1/8 - 5/8	3-16	3	2.3	4.33	1/4 - 5/8

## 5312

- Driver arbors for reamers

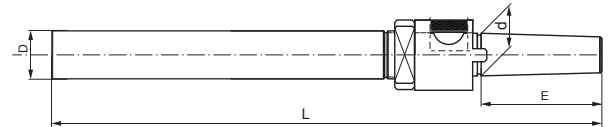

Code No.	Shank D [in]	d [in]	L [in]	E [in]			
7-068-004	1/2	3/8	9.00	2.25	7-068-954	7-068-904	7-068-804
7-068-005	5/8	1/2	9.50	2.50	7-068-955	7-068-905	7-068-804
7-068-006	3/4	5/8	10.00	2.75	7-068-956	7-068-906	7-068-806
7-068-007	7/8	3/4	11.00	3.00	7-068-957	7-068-907	7-068-807
7-068-008	1.1/8	1	12.00	3.50	7-068-958	7-068-908	7-068-807
7-068-009	1.3/8	1.1/4	13.00	3.75	7-068-959	7-068-909	7-068-809
7-068-010	1.5/8	1.1/2	15.55	4.00	7-068-960	7-068-910	7-068-810
7-068-011	2	1.3/4	16.73	4.50	7-068-961	7-068-911	7-068-811
7-068-012	2.1/8	2	17.52	5.00	7-068-962	7-068-912	7-068-811

## 5275

- Floating reamer holders
- Through spindle coolant capacity
- Balanced 7,000 RPM
- Parallel float +/- 0.002"

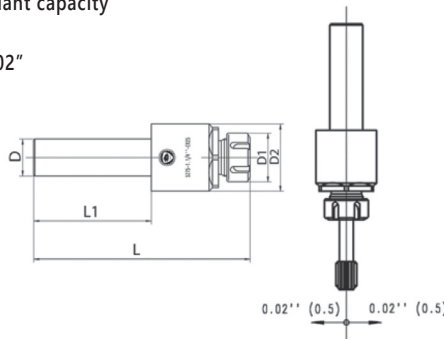

Code No.	D [in]	Collet Size	L [in]	L1 [in]	D1 [in]	D2 [in]	Nut	Wrench
7-162-255	1-1/4	ER25	7.35	4	1.65	2.284	7-188-825	7-188-925
7-162-250	1	ER25	7.35	4	1.65	2.284	7-188-825	7-188-925

## 7817

- DA straight shank collet extensions



Code No.	D1 [in]	Collet Type	L [in]	D [in]	Nut	Wrench
7-167-003	3/4	DA200	5.5	0.86	7-193-805S	7-193-905S
7-167-004	3/4	DA200	7.5	0.86	7-193-805S	7-193-905S
7-167-005	1	DA100	5.5	1.09	7-193-810	7-193-910
7-167-010	1	DA100	7.5	1.09	7-193-810	7-193-910
7-167-023	1-1/4	DA180	3.0	1.54	7-193-818	7-193-918
7-167-025	1-1/4	DA180	5.5	1.54	7-193-818	7-193-918