

7652

- Double angle collet chucks
- Wrenches sold separately

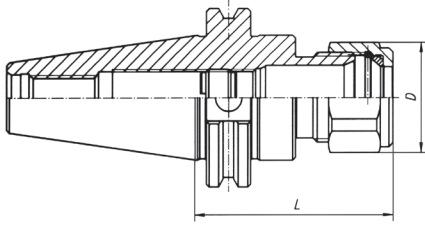

Code No.	K 7:24	Collet size	L [in]	D [in]	Clamping range	RPM		
7-193-150	CAT40	DA 200	3.00	1.07	0.125 - 0.563	25,000	7-193-805	7-193-905
7-193-415	CAT40	DA 180	2.75	1.54	0.125 - 0.750	25,000	7-193-818	7-193-918
7-193-424	CAT40	DA 180	4.00	1.54	0.125 - 0.750	25,000	7-193-818	7-193-918
7-193-524	CAT50	DA 180	4.00	1.54	0.125 - 0.750	25,000	7-193-818	7-193-918
7-193-526	CAT50	DA 180	6.00	1.54	0.125 - 0.750	25,000	7-193-818	7-193-918
7-193-528	CAT50	DA 180	8.00	1.54	0.125 - 0.750	25,000	7-193-818	7-193-918

7636 M-AD

- Weldon type metric end mill holders
- Through the spindle coolant capacity
- Balancing on request- 15,000 RPM (G6.3)

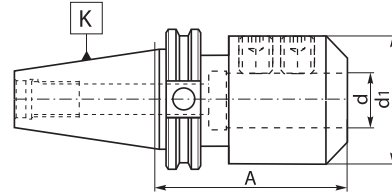

Code No. 7000 RPM	K 7:24	d [mm]	A [in]	d ₁ [mm]	
7-185-6400	CAT40	6	2.50	25	7-195-006M
7-185-6402	CAT40	6	4.00	25	7-195-006M
7-185-6404	CAT40	8	2.50	28	7-195-008M
7-185-6406	CAT40	10	2.50	35	7-195-010M
7-185-6408	CAT40	12	2.50	42	7-195-012M
7-185-6410	CAT40	16	3.00	48	7-195-014M
7-185-6412	CAT40	20	3.00	52	7-195-016M
7-185-6414	CAT40	25	4.00	63	7-195-018M x2
7-185-6416	CAT40	25	6.00	63	7-195-018M x2
7-185-6418	CAT40	32	4.00	72	7-195-020M x2
7-185-6420	CAT40	32	6.00	72	7-195-020M x2
7-185-6500	CAT50	10	2.50	35	7-195-010M
7-185-6502	CAT50	10	4.50	35	7-195-010M
7-185-6504	CAT50	20	3.75	52	7-195-016M
7-185-6506	CAT50	16	3.75	48	7-195-014M
7-185-6508	CAT50	16	5.75	48	7-195-014M
7-185-6510	CAT50	12	4.5	42	7-195-012M
7-185-6512	CAT50	12	2.50	42	7-195-012M
7-185-6514	CAT50	20	5.75	52	7-195-016M
7-185-6516	CAT50	25	4.00	63	7-195-018M x2
7-185-6518	CAT50	25	6.00	63	7-195-018M x2
7-185-6520	CAT50	32	4.00	72	7-195-020M x2
7-185-6522	CAT50	32	6.00	72	7-195-020M x2
7-185-6524	CAT50	40	6.00	80	7-195-020M x2
7-185-6526	CAT50	40	4.00	80	7-195-020M x2

7614

- TG collet chucks
- Wrenches sold separately

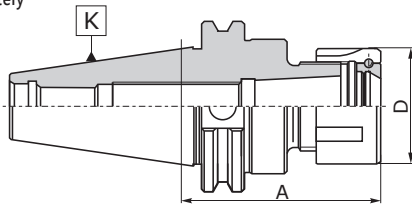

Code No.	K 7:24	Collet size	A [in]	D [in]	Clamping range	RPM		
7-180-401	CAT40	TG75	3.00	2.125	0.125 - 0.750	25,000	7-180-901	7-188-932
7-180-403	CAT40	TG100	3.000	2.500	0.938 - 1.000	25,000	7-180-9100	7-180-930
7-180-404	CAT40	TG100	4.000	2.500	0.938 - 1.000	25,000	7-180-9100	7-180-930
7-180-501	CAT50	TG75	3.000	2.125	0.125 - 0.750	25,000	7-180-901	7-188-932
7-180-503	CAT50	TG100	3.125	2.500	0.938 - 1.000	25,000	7-180-9100	7-180-930
7-180-504	CAT50	TG100	3.500	2.500	0.938 - 1.000	15,000	7-180-9100	7-180-930
7-180-505	CAT50	TG100	5.500	2.500	0.938 - 1.000	25,000	7-180-9100	7-180-930
7-180-507	CAT50	TG100	7.500	2.500	0.938 - 1.000	15,000	7-180-9100	7-180-930
7-180-513	CAT50	TG150	3.000	3.500	0.500 - 1.500	25,000	7-180-9150	7-180-935
7-180-514	CAT50	TG150	3.500	3.500	0.500 - 1.500	25,000	7-180-9150	7-180-935
7-180-517	CAT50	TG150	5.500	3.500	0.500 - 1.500	15,000	7-180-9150	7-180-935