

## 7385

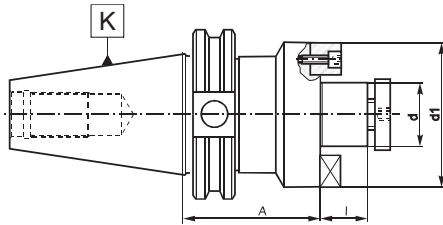

### ■ Shell mill holders



Code No.	K 7:24	d [in]	A [in]	I [in]	d1 [in]	RPM			Key Screw
7-186-005	CAT40	1/2"	1.375	0.563	1.375	25,000 (G2.5)	7-080-005	7-080-105	7-080-150
7-186-405	CAT40	3/4"	1.375	0.688	1.750	25,000 (G2.5)	7-080-010	7-080-110	7-080-155
7-186-015	CAT40	3/4"	4.000	0.688	1.750	25,000 (G2.5)	7-080-010	7-080-110	7-080-155
7-186-020	CAT40	1"	2.063	0.688	2.250	25,000 (G2.5)	7-080-015	7-080-115	7-080-160
7-186-025	CAT40	1"	4.000	0.688	2.250	25,000 (G2.5)	7-080-015	7-080-115	7-080-160
7-186-409	CAT40	1-1/4"	2.125	0.688	2.750	25,000 (G2.5)	7-080-020	7-080-120	-
7-186-035	CAT40	1-1/4"	4.000	0.688	2.750	25,000 (G2.5)	7-080-020	7-080-120	-
7-186-411	CAT40	1-1/2"	2.400	0.938	3.750	25,000 (G2.5)	7-080-025	7-080-125	-
7-186-045	CAT40	1-1/2"	4.000	0.938	3.750	25,000 (G2.5)	7-080-025	7-080-125	-
7-186-503	CAT50	1/2"	1.500	0.563	1.375	25,000 (G2.5)	7-080-005	7-080-105	7-080-150
7-186-505	CAT50	1/2"	3.500	0.563	1.375	25,000 (G2.5)	7-080-005	7-080-105	7-080-150
7-186-507	CAT50	1/2"	5.500	0.563	1.375	15,000 (G6.3)	7-080-005	7-080-105	7-080-150
7-186-509	CAT50	3/4"	1.500	0.688	1.750	25,000 (G2.5)	7-080-010	7-080-110	7-080-155
7-186-511	CAT50	3/4"	3.500	0.688	1.750	25,000 (G2.5)	7-080-010	7-080-110	7-080-155
7-186-512	CAT50	3/4"	4.500	0.688	1.750	15,000 (G6.3)	7-080-010	7-080-110	7-080-155
7-186-513	CAT50	3/4"	5.500	0.688	1.750	15,000 (G6.3)	7-080-010	7-080-110	7-080-155
7-186-514	CAT50	3/4"	9.000	0.688	1.750	15,000 (G6.3)	7-080-010	7-080-110	7-080-155
7-186-515	CAT50	1"	2.000	0.688	2.250	25,000 (G2.5)	7-080-015	7-080-115	7-080-160
7-186-517	CAT50	1"	4.000	0.688	2.250	25,000 (G2.5)	7-080-015	7-080-115	7-080-160
7-186-519	CAT50	1"	6.000	0.688	2.250	15,000 (G6.3)	7-080-015	7-080-115	7-080-160
7-186-520	CAT50	1"	10.000	0.688	2.250	15,000 (G6.3)	7-080-015	7-080-115	7-080-160
7-186-521	CAT50	1-1/4"	1.500	0.688	2.750	25,000 (G2.5)	7-080-020	7-080-120	7-080-160
7-186-523	CAT50	1-1/4"	3.500	0.688	2.750	25,000 (G2.5)	7-080-020	7-080-120	7-080-160
7-186-525	CAT50	1-1/4"	5.500	0.688	2.750	15,000 (G6.3)	7-080-020	7-080-120	7-080-160
7-186-526	CAT50	1-1/4"	12.000	0.688	2.750	15,000 (G6.3)	7-080-020	7-080-120	7-080-160
7-186-527	CAT50	1-1/2"	2.400	0.938	3.750	25,000 (G2.5)	7-080-025	7-080-125	-
7-186-529	CAT50	1-1/2"	4.000	0.938	3.750	25,000 (G2.5)	7-080-025	7-080-125	-
7-186-531	CAT50	1-1/2"	6.000	0.938	3.750	15,000 (G6.3)	7-080-025	7-080-125	-
7-186-532	CAT50	1-1/2"	12.000	0.938	3.750	15,000 (G6.3)	7-080-025	7-080-125	-
7-186-533	CAT50	2"	2.400	0.938	4.875	25,000 (G2.5)	7-080-030	7-080-130	7-080-175
7-186-535	CAT50	2"	4.000	0.938	4.875	25,000 (G2.5)	7-080-030	7-080-130	7-080-175
7-186-537	CAT50	2"	6.000	0.938	4.875	15,000 (G6.3)	7-080-030	7-080-130	7-080-175
7-186-540	CAT50	2-1/2"	2.400	1.125	4.875	25,000 (G2.5)	7-080-035	7-080-135	7-080-175
7-186-541	CAT50	2-1/2"	4.000	1.125	4.875	25,000 (G2.5)	7-080-035	7-080-135	7-080-175
7-186-543	CAT50	2-1/2"	6.000	1.125	4.875	15,000 (G6.3)	7-080-035	7-080-135	7-080-175

## 7658



### ■ Keyless drill chucks with integral CAT flange

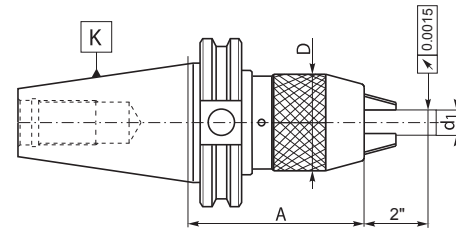

Code No.	K 7:24	d <sub>1</sub> [mm]	d <sub>1</sub> [in]	A [in]	D [in]
7-187-433	CAT40	1-13	0.0313 - 0.5000	4.13	2.00
7-187-435	CAT40	3-16	0.1250 - 0.6250	5.12	2.25
7-187-563	CAT50	1-13	0.0313 - 0.5000	4.13	2.00
7-187-565	CAT50	3-16	0.1250 - 0.6250	4.33	2.25

## 1690



### ■ Reducing adapters for tools with 7:24 shank

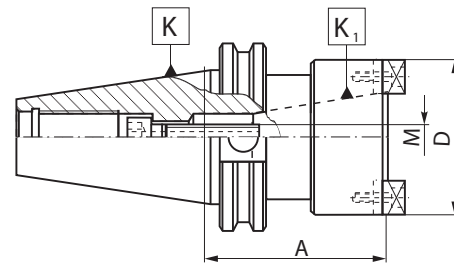

Code No.	K 7:24	K <sub>1</sub> 7:24	A [in]	D [in]	M [in]		
7-184-504	CAT50	CAT40	3.15	3.46	5/8"-11	7-184-802	7-184-902