

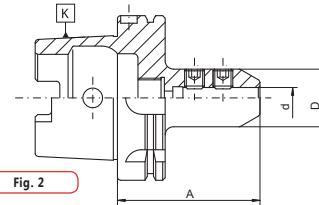

**7885**

■ Weldon type end mill holders

Code No.	K HSK-A	d [in]	D [in]	L [in]		Fig. / No. of screws
7-306-6005	63	3/16	0.75	3.00	7-195-110	1
7-306-6010	63	1/4	0.82	3.00	7-195-110	1
7-306-6015	63	5/16	1.00	3.00	7-195-120	1
7-306-6020	63	3/8	1.00	3.50	7-195-120	1
7-306-6025	63	7/16	1.25	4.00	7-195-120	1
7-306-6030	63	1/2	1.25	4.00	7-195-312	1
7-306-6035	63	5/8	1.50	4.00	7-195-415	1
7-306-6040	63	3/4	1.75	4.50	7-195-513	1
7-306-6045	63	7/8	2.00	4.50	7-195-517	2
7-306-6050	63	1	2.25	4.50	7-195-618	2
7-306-6054	63	1-1/4	2.50	4.50	7-195-618	2

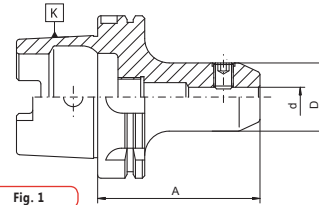

**5391**

■ Keyless drill chucks

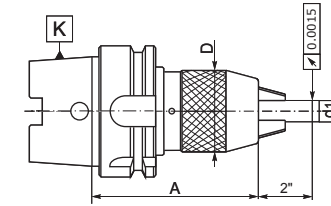

Code No.	K HSK-A	d <sub>1</sub> [in]	A [in]	D [in]
7-311-6005	63	0.0313 - 0.5000	5.85	2.00
7-311-6008	63	0.1250 - 0.6250	6.18	2.25

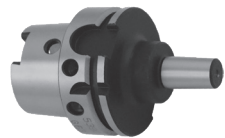

**5390**

■ DIN69893-A (HSK) drill chuck adapters for Jacobs taper

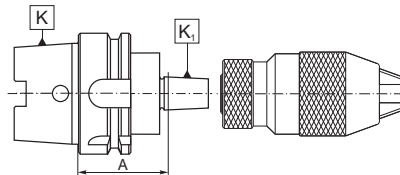



Code No.	K HSK-A	K <sub>1</sub> Jacobs	A [in]
7-309-6001	63	J1	1.75
7-309-6004	63	J4	1.75
7-309-6005	63	J5	1.75
7-309-6006	63	J6	1.75
7-309-6035	63	J33	1.75

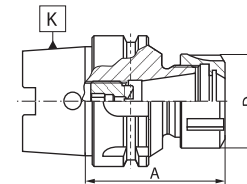

**7887**

■ Collet chucks for ER collets



Code No.	K HSK-A	Collet size	Clamping range [in]	A [in]	D [in]		
7-305-6253	63	ER25	0.047 - 0.625	3.15	1.654	7-188-825	7-188-9025
7-305-6321	63	ER32	0.125 - 0.750	3.00	1.969	7-188-832	7-188-9032
7-305-6401	63	ER40	0.125 - 1.000	3.15	2.480	7-188-840	7-188-9040
7-305-6402	63	ER40	0.125 - 1.000	5.00	2.480	7-188-840	7-188-9040



**7891**

■ Machinable blank adapters

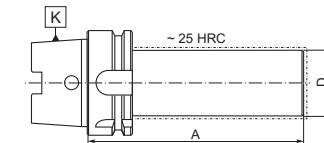

Code No.	K HSK-A	D [mm]	A [mm]
7-308-632	63	63	150
7-308-634	63	80	250
7-608-102	100	97	250

**2856**

■ Control arbor

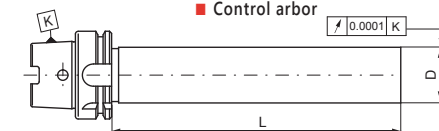

Code No.	K HSK-A	D [mm]	L [mm]
7-307-632	63	40	300
7-307-102	100	50	300