

1875

- Solid sockets with MT hole

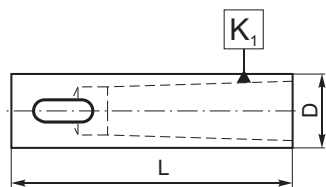

Code No.	Socket Number	L [in]	K ₁ MT	D [in]
7-400-005	1	3-1/2	1	1
7-400-010	2	3-1/2	1	1-1/4
7-400-015	3	3-1/2	1	1-1/2
7-400-020	4	4	2	1
7-400-025	5	4	2	1-1/4
7-400-030	6	4	2	1-1/2
7-400-035	7	4	2	1-3/4
7-400-040	8	4	2	2
7-400-045	9	4-3/4	3	1-1/4
7-400-050	10	4-3/4	3	1-1/2
7-400-055	11	4-3/4	3	1-3/4
7-400-060	12	4-3/4	3	2
7-400-065	13	6	4	1-1/2
7-400-070	14	6	4	1-3/4
7-400-075	15	6	4	2
7-400-080	16	7-3/8	5	2-1/4
7-400-085	17	7-3/8	5	2-1/2
7-400-090	18	10-1/8	6	3-1/4
7-400-095	19	10-1/8	6	3-1/2

5353

- Jacobs taper adapters



Code No.	D [in]	L [in]	L [in]	Jacobs Taper K1
7-052-700	1/2	2.5	3.1	0
7-052-701	1/2	2.5	3.3	1
7-052-702	1/2	2.5	3.5	2
7-052-703	1/2	2.5	3.9	3
7-052-7033	1/2	2.5	3.7	33
7-052-706	1/2	2.5	3.7	6
7-052-721	5/8	2.5	3.3	1
7-052-722	5/8	2.5	3.5	2
7-052-723	5/8	2.5	3.9	3
7-052-7233	5/8	2.5	3.5	33
7-052-726	5/8	2.5	3.6	6
7-052-742	3/4	3.0	4.0	2
7-052-743	3/4	3.0	4.3	3
7-052-7433	3/4	3.0	4.1	33
7-052-744	3/4	3.0	4.8	4
7-052-746	3/4	3.0	4.1	5
7-052-762	1	3.0	4.1	2
7-052-763	1	3.0	4.3	3
7-052-7633	1	3.0	4.2	33
7-052-764	1	3.0	4.8	4
7-052-766	1	3.0	4.2	6

7817

- DA straight shank collet extensions



Code No.	D1 [in]	Collet Type	L [in]	D [in]	Nut	Wrench
7-167-003	3/4	DA200	5.5	0.86	7-193-805S	7-193-905S
7-167-004	3/4	DA200	7.5	0.86	7-193-805S	7-193-905S
7-167-005	1	DA100	5.5	1.09	7-193-810	7-193-910
7-167-010	1	DA100	7.5	1.09	7-193-810	7-193-910
7-167-023	1-1/4	DA180	3.0	1.54	7-193-818	7-193-918
7-167-025	1-1/4	DA180	5.5	1.54	7-193-818	7-193-918

5275

- Floating reamer holders
- Through spindle coolant capacity
- Balanced 7,000 RPM
- Parallel float +/- 0.002"

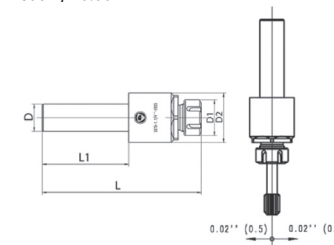

Code No.	D [in]	Collet Size	L [in]	L1 [in]	D1 [in]	D2 [in]	Nut	Wrench
7-162-255	1-1/4	ER25	7.35	4	1.65	2.284	7-188-825	7-188-925
7-162-250	1	ER25	7.35	4	1.65	2.284	7-188-825	7-188-925